

# YERBA BUENA BALLROOM

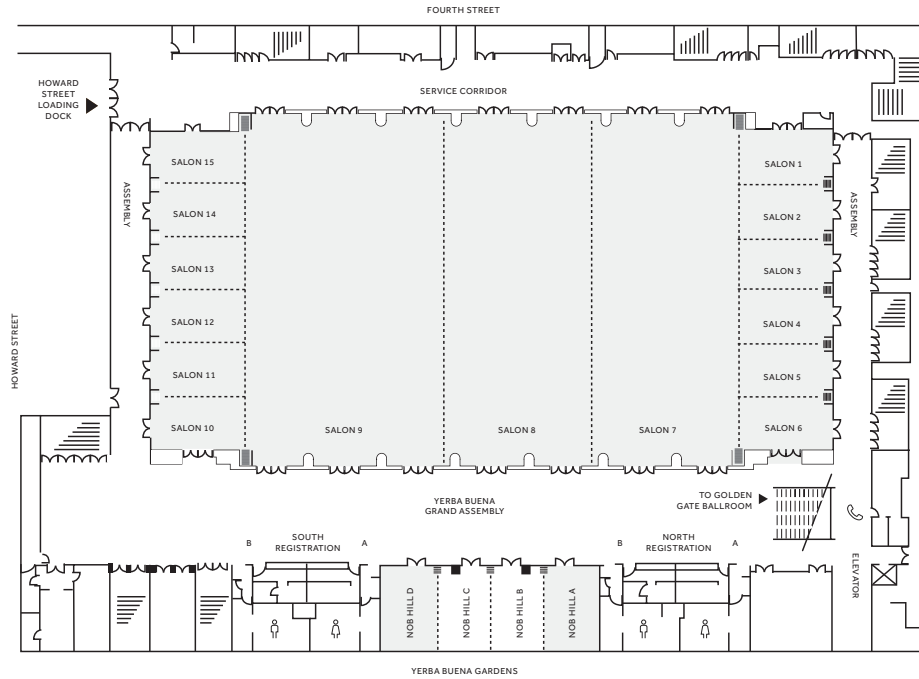

MEETING ROOMS	DIMENSIONS		CAPACITY						
	LxWxH	SQ FT	Conference	U-Shape	Theatre	Classroom	Banquet	Reception	8x10 Exhibits
YERBA BUENA BALLROOM	147x284.1x24.5	39,663	—	—	4,380	2,376	3,120	5,500	240
SALON 1	21.9x39.7x18.5	831	30	30	80	45	60	110	—
SALON 2	22x39.7x18.5	836	30	30	80	45	60	110	—
SALON 3	22x39.7x18.5	835	30	30	80	45	60	110	—
SALON 4	21.9x39.8x18.5	832	30	30	80	45	60	110	—
SALON 5	22x39.7x18.5	837	30	30	80	45	60	110	—
SALON 6	22x39.7x18.5	836	30	30	80	45	60	110	—
SALONS 1 - 6 COMBINED	131.8x39.7x18.5	5,007	—	—	496	324	360	720	23
SALON 7	147x59.4x24.5	8,586	—	—	858	546	600	1,150	50
SALON 8	147x61.5x24.5	8,927	—	—	858	546	600	1,175	50
SALON 9	147x83.9x24.5	12,168	—	—	1,254	750	840	1,600	74
SALONS 7 - 9 COMBINED	147x204.8x24.5	29,681	—	—	2,970	1,842	2,040	3,925	174
SALON 10	22x39.5x18.5	831	30	30	80	45	60	110	—
SALON 11	22x39.5x18.5	831	30	30	80	45	60	110	—
SALON 12	21.9x39.5x18.5	826	30	30	80	45	60	110	—
SALON 13	22x39.5x18.5	830	30	30	80	45	60	110	—
SALON 14	22x39.5x18.5	831	30	30	80	45	60	110	—
SALON 15	21.9x39.5x18.5	826	30	30	80	45	60	110	—
SALONS 10 - 15 COMBINED	131.8x39.5x18.5	4,975	—	—	496	324	360	720	23
NOB HILL	33.5x89x13.4	2,836	76	83	308	156	200	360	16
NOB HILL A	33.4x22.1x13.4	710	28	26	82	45	50	90	—
NOB HILL B	33.4x22.4x13.4	695	28	26	84	45	50	90	—
NOB HILL C	33.4x22.5x13.4	697	28	26	84	45	50	90	—
NOB HILL D	33.5x22x13.4	711	28	26	82	45	50	90	—
YERBA BUENA GRAND ASSEMBLY	186.5x360x11.9	17,027	—	—	—	—	—	1,650	—

Note: Exhibit capacities are subject to San Francisco Fire Marshal approval.

**SAN FRANCISCO MARRIOTT MARQUIS**  
 780 Mission Street, San Francisco, CA 94103  
 415.896.1600  
 SFMarriottMarquis.com



# GOLDEN GATE BALLROOM

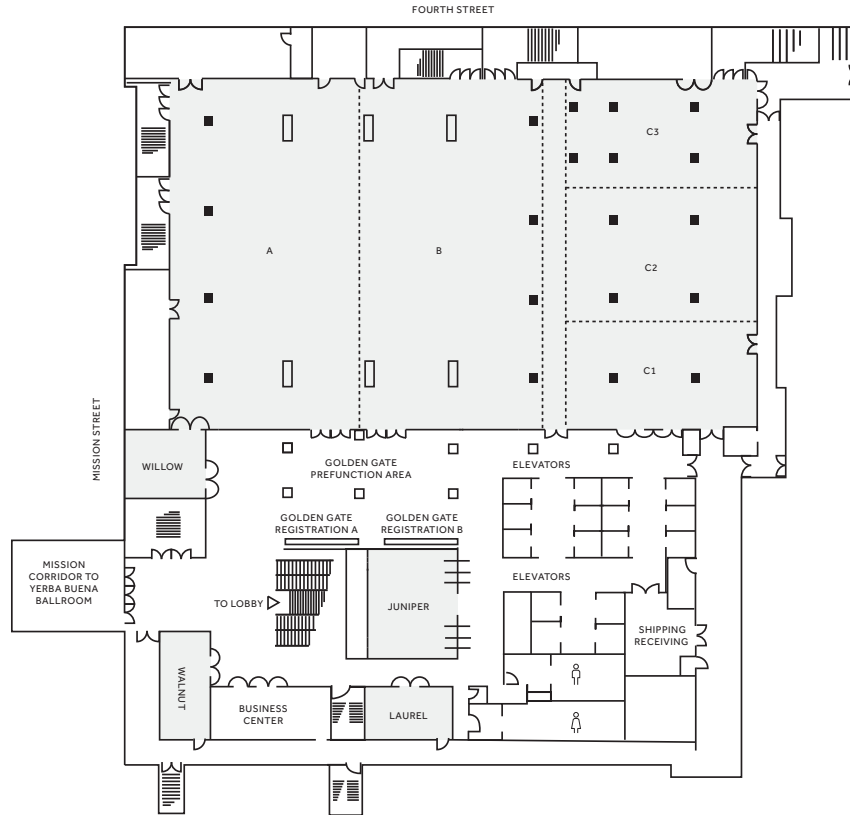

MEETING ROOMS	DIMENSIONS		CAPACITY						
	LxWxH	SQ FT	Conference	U-Shape	Theatre	Classroom	Banquet	Reception	8x10 Exhibits
<b>GOLDEN GATE BALLROOM</b>	<b>116.3x197.4x14</b>	<b>22,563</b>	—	—	<b>1,364</b>	<b>616</b>	<b>1,410</b>	<b>2,375</b>	<b>126</b>
Golden Gate A	116.3x65.7x14	7,538	—	—	532	276	480	795	—
Golden Gate B	116.4x59.3x14	6,736	—	—	576	306	430	710	—
Golden Gate A - B combined	116.4x125x14	14,274	—	—	1,000	600	930	1,505	64
Golden Gate C combined and Corridor	116.4x72.4x9.5	8,289	—	—	639	306	450	875	38
Golden Gate C1	37.1x63.1x9.5	2,304	28	29	161	90	130	245	—
Golden Gate C2	40.8x63.1x9.5	2,533	42	41	232	108	140	270	—
Golden Gate C3	38.5x63.1x9.5	2,369	28	29	120	90	120	250	—
Golden Gate Prefunction	161.3x86x10.5	9,416	—	—	—	—	—	995	—
JUNIPER	27.4x27x9	732	18	20	72	36	40	80	—
LAUREL	17.4x29.5x9	490	22	23	42	30	30	55	—
WALNUT	16.8x35.6x9	581	24	29	54	36	30	65	—
WILLOW	27.6x23.8x9	606	22	23	72	36	40	65	—

Note: Exhibit capacities are subject to San Francisco Fire Marshal approval.

**SAN FRANCISCO MARRIOTT MARQUIS**  
 780 Mission Street, San Francisco, CA 94103  
 415.896.1600  
 SFMarriottMarquis.com



# FOOTHILL MEETING ROOMS

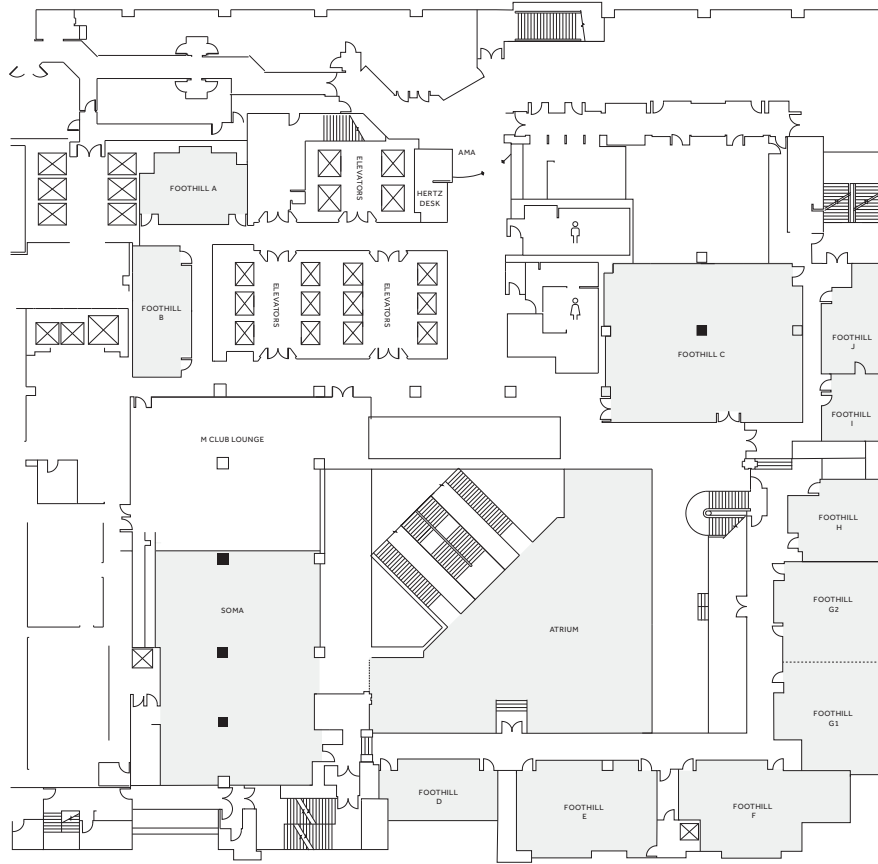

MEETING ROOMS	DIMENSIONS		CAPACITY						
	LxWxH	SQFT	Conference	U-Shape	Hollow Square	Theatre	Classroom	Banquet	Reception
FOOTHILL A	22.3x30.9x8	567	22	20	24	53	30	40	60
FOOTHILL B	17x36.8x8	592	30	29	34	61	33	30	60
FOOTHILL C	56x45x11.5	2,414	42	42	48	220	126	160	310
FOOTHILL D	34.5x22.1x10	676	24	23	28	60	42	50	85
FOOTHILL E	27.8x40.6x10.5	1,055	34	38	40	110	63	60	100
FOOTHILL F	27.8x49.5x10.5	1,038	42	26	30	111	60	60	100
FOOTHILL G	32.1x60.5x10.5	1,672	48	50	58	159	96	120	250
FOOTHILL G1	32.1x35.4x10.5	949	24	26	34	83	54	60	100
FOOTHILL G2	32.1x25.1x10.5	723	18	26	28	55	39	50	100
FOOTHILL H	28.1x23.4x10.5	517	22	17	18	43	24	30	60
FOOTHILL I	17.1x12.4x11.8	212	8*	—	—	—	—	—	—
FOOTHILL J	17x36.6x11.2	533	24	23	24	46	27	30	45
FOOTHILL FOYER	93.3x115.9x9	2,588	—	—	—	—	—	—	275
ATRIUM	97.1x75.4x64.6	5,112	—	—	—	—	—	300**	500**
SOMA	63x60x10	3,780	56	60	64	180	100	170 - 210	200
SOMA AND ATRIUM COMBINED	—	—	—	—	—	—	—	600	800
SECOND LEVEL COMBINED (ATRIUM, SOMA, FOOTHILL MEETING ROOMS)	—	—	—	—	—	—	—	900	1,200

\*Permanent boardroom table. Minimal to no audiovisual.  
 \*\*Furniture removal fee.

**SAN FRANCISCO MARRIOTT MARQUIS**  
 780 Mission Street, San Francisco, CA 94103  
 415.896.1600  
 SFMarriottMarquis.com



# PACIFIC CONFERENCE SUITES

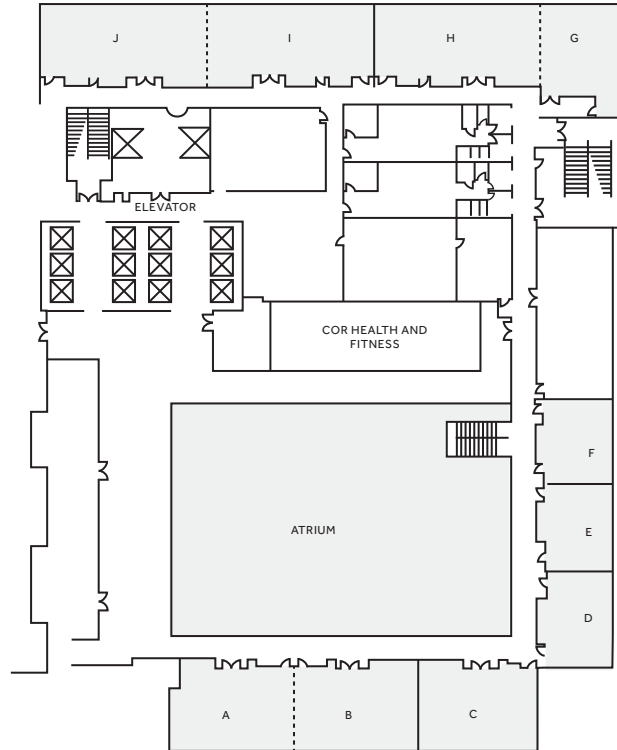

MEETING ROOMS	DIMENSIONS		CAPACITY						
	LxWxH	SQFT	Conference	U-Shape	Hollow Square	Theatre	Classroom	Banquet	Reception
PACIFIC A	26.5x40.4x7.7	915	34	33	34	70	42	50	95
PACIFIC B	26.5x41x7.8	921	34	33	34	70	42	50	95
PACIFIC A-B	52x81x15.5	1,836	68	66	68	140	84	100	190
PACIFIC C	26.6x42.1x7.7	948	34	33	34	70	42	50	100
PACIFIC D	27.2x31.52x7.7	670	22	20	22	53	30	40	60
PACIFIC E	27.1x29.5x7.8	646	22	23	22	56	30	30	68
PACIFIC F	27.2x26.5x7.8	572	22	23	22	48	24	30	60
PACIFIC G	38.8x26.3x7.8	723	22	20	22	48	24	30	60
PACIFIC H	26.5x54.2x7.8	1,208	46	47	46	90	54	60	128
PACIFIC G-H	65.3x80.5x15.6	1,931	68	70	68	138	78	90	188
PACIFIC I	26.5x54.8x7.8	1,233	46	47	46	90	54	60	128
PACIFIC J	26.5x54.1x7.8	1,204	46	47	46	90	54	60	128
PACIFIC I-J	53x109x15.6	2,437	92	94	92	180	108	120	256

Note: All conference suites have windows.

**SAN FRANCISCO MARRIOTT MARQUIS**  
 780 Mission Street, San Francisco, CA 94103  
 415.896.1600  
 SFMarriottMarquis.com



# SIERRA CONFERENCE SUITES

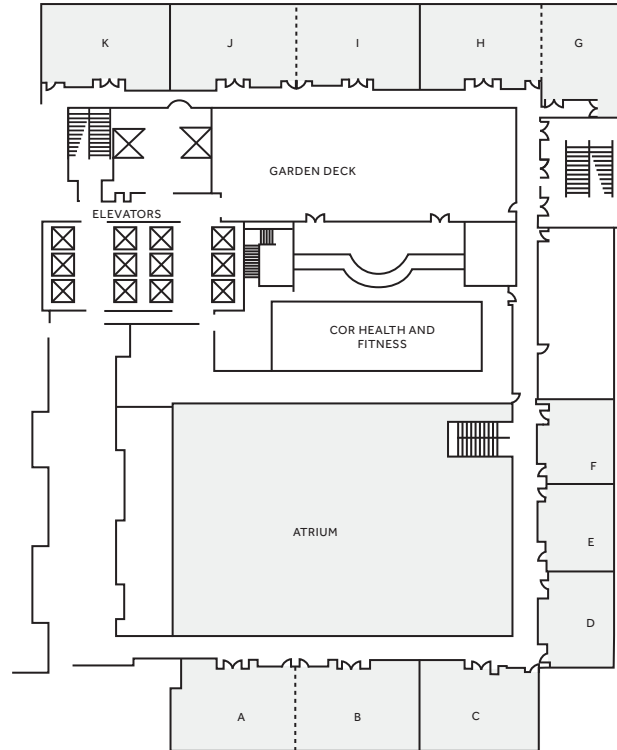

MEETING ROOMS	DIMENSIONS		CAPACITY						
	LxWxH	SQFT	Conference	U-Shape	Hollow Square	Theatre	Classroom	Banquet	Reception
SIERRA A	26.5x40.4x7.8	920	34	33	34	70	42	50	95
SIERRA B	26.4x41x7.8	926	34	33	34	70	42	50	95
SIERRA A-B	52.9x81.4x15.6	1,846	68	66	68	140	84	100	190
SIERRA C	26.4x42.4x7.7	945	34	33	34	70	42	50	100
SIERRA D	27.1x32x7.8	693	22	20	24	53	30	40	60
SIERRA E	27x29.5x7.7	654	22	23	22	56	30	30	68
SIERRA F	27.2x26.6x7.7	575	22	23	22	48	24	30	60
SIERRA G	38.2x26.3x7.7	745	22	23	22	48	24	30	60
SIERRA H	25.5x40.4x7.8	873	34	33	34	60	42	50	90
SIERRA G-H	63.7x66.7x15.5	1,618	56	56	56	108	66	80	150
SIERRA I	25.4x41x7.8	872	34	33	34	60	42	50	95
SIERRA J	25.5x41.3x7.8	883	34	33	34	60	42	50	95
SIERRA I-J	50.8x82.3x15.6	1,755	68	66	68	120	84	100	190
SIERRA K	25.4x40x7.8	856	34	33	34	60	42	50	90

Note: All conference suites have windows.

**SAN FRANCISCO MARRIOTT MARQUIS**  
 780 Mission Street, San Francisco, CA 94103  
 415.896.1600  
 SFMarriottMarquis.com



# THE VIEW

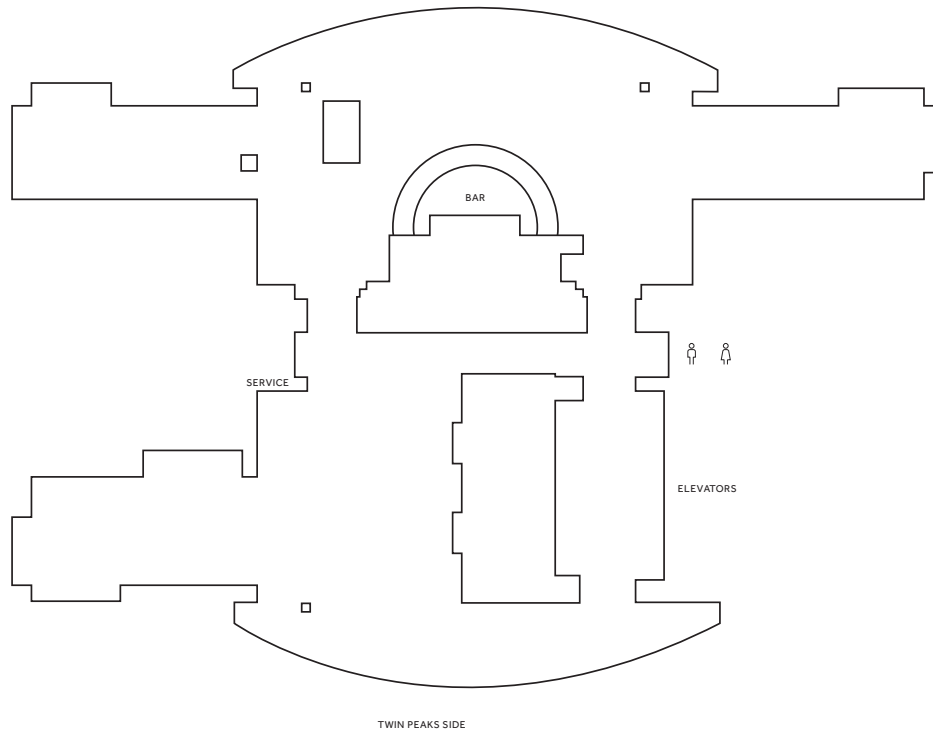

MEETING ROOMS	DIMENSIONS		CAPACITY
	LxWxH	SQ FT	
THE VIEW	83x113x12	4,660	329 (150 Twin Peaks side only)

**SAN FRANCISCO MARRIOTT MARQUIS**  
 780 Mission Street, San Francisco, CA 94103  
 415.896.1600  
 SFMarriottMarquis.com

